

DATA SHEET



BLACK LED LINEAR LIGHT 48W 1500MM



AVAILABLE MODELS	
Color Temp	REF No
3000K	907469
4000K	907470
6000K	907471

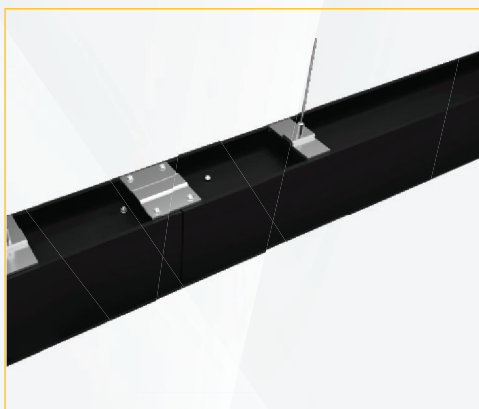

DATA SHEET



BLACK LED LINEAR LIGHT 48W 1500MM

ELECTRICAL DATA

Wattage (Consumption)	48W
Voltage	AC200-240V
Power Factor	≥0.5

PHOTOMETRICAL DATA

Temperature (Kelvin)	3000K, 4000K, 6000K
Light color	White
Luminous efficiency	110LM/W / 120LM/W
Lumen	5280LM±10% / 5760LM±10%
Beam angle	120°
Color Rendering Index (CRI)	≥0,80

CAPABILITIES

Dimmable	No
----------	----

LIFESPAN & WARRANTY

Lifespan	50.000 hrs
Warranty	5 years

DIMENSIONS & PACKAGING

Product Dimensions	L1498*W55*H75mm
Inner box	1 piece
Outer box	10 pieces

ADDITIONAL INFORMATION

Housing color	Black
IP Rating	IP20
Housing color	Aluminium & polycarbonate
Certificates	CE & ROHS

AVAILABLE MODELS

Color Temp	REF No
3000K	907469
4000K	907470
6000K	907471



DATA SHEET



BLACK LED LINEAR LIGHT 48W 1500MM

TEST REPORT

IETM NO.:SLL-48WSMD 1.5M

LUMINOUS INTENSITY DISTRIBUTION DIAGRAM

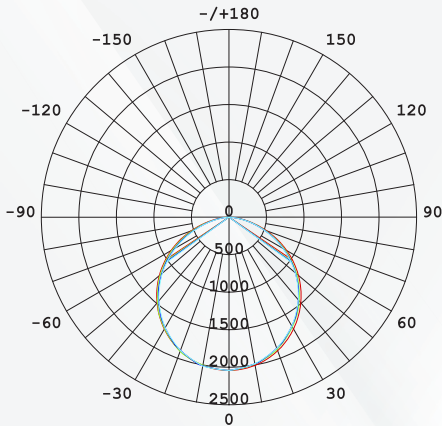

AVERAGE BEAM ANGLE (50%) : 109.9 DEG

UNIT: cd

- C0/180, 112.0deg
- C30/210, 110.3deg
- C60/240, 109.0deg
- C90/270, 108.1deg

PLANAR ISOLUX DIAGRAM (UNIT: lx)

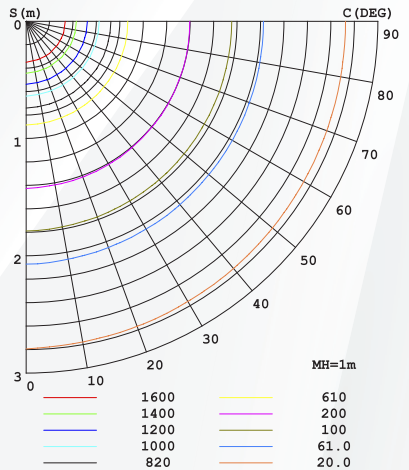

Flux out:4011 lm

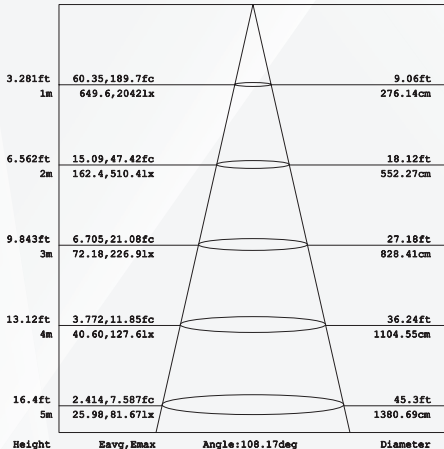

Note: The Curves indicate the illuminated area and the average illumination when the luminaire is at different distance.

DATA SHEET



BLACK LED LINEAR LIGHT 48W 1500MM

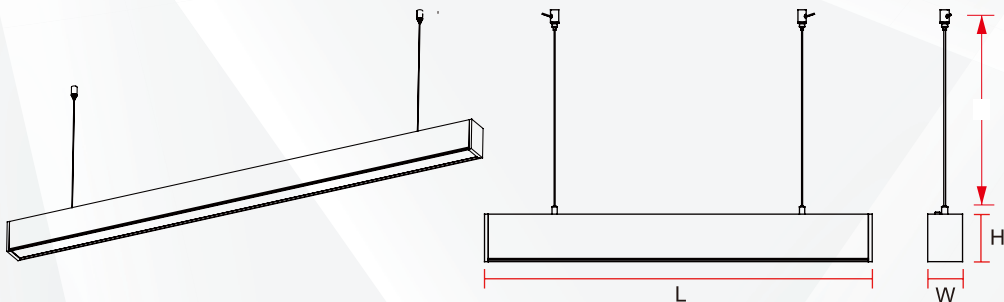

ITEM NO.	POWER	PRODUCT SIZE(L*W*H)	SUSPENSION LENGTH(SL)
SLL-18WSMD	18W	L588*W55*H75mm	1000mm
SLL-36WSMD	36W	L1198*W55*H75mm	1000mm
SLL-48WSMD	48W	L1498*W55*H75mm	1000mm

Suspension length 1000mm is standard configuration, Other lengths can be customized.

MANUAL INSTRUCTION



Safety Notice:

- 1 Installation should be done by registered electricians.
- 2 Never touch the working luminaire
- 3 In any case of malfunction, switch off the power supply immediately, and do not try to repair it yourself.
- 4 Repairment should only be done by registered electricians or official service agent.

Included



Not Included

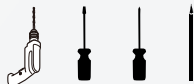

DATA SHEET



BLACK LED LINEAR LIGHT 48W 1500MM

If In Series

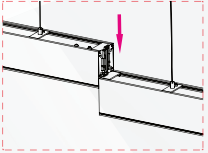

Item No.	Connection / Qty Max(pcs)
SLL-18WSMD	40
SLL-36WSMD	20
SLL-48WSMD	16

This connection QTY refers to the case of direct 1 cable line, If more lamps need to be connected in series, just connect a few more wires; It is recommended that the load of one input line be less than 800W.



WARNING
Switch off the power supply before installation

Suspending



Step 1: Take the kit out of the box;

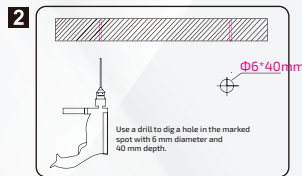

Step 2: Drill holes in the installation position;

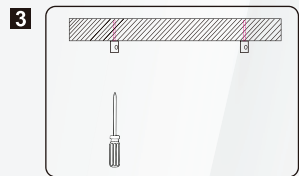

Step 3: Attach the ceiling holder to the ceiling with long screws;

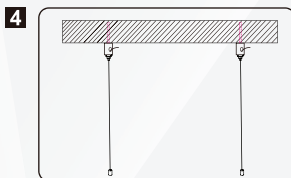

Step 4: Thread the wire rope into the top seat and tighten the wire lock on the top seat;

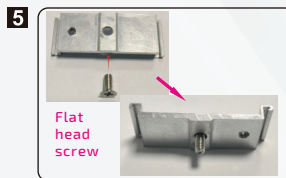

Step 5: Screw the flat head to the small aluminum piece;



Step 6: Remove the protective cover from the side of the light fixture by hand, and then insert the small aluminum sheet;

DATA SHEET

BLACK LED LINEAR LIGHT 48W 1500MM

If In Series

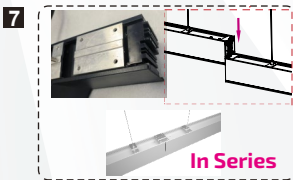

Step 7: If it is in series, it also needs to be loaded with large aluminum sheets;

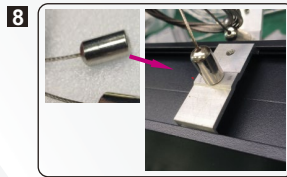

Step 8: Lock the lower end of the wire rope to the screw of the small aluminum piece;

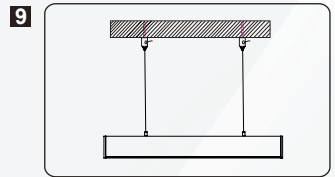

Step 9: Complete installation (rope height adjustable);

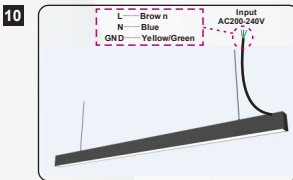

Step 10: Connect the lamp cable to the mains;



! WARNING

Switch off the power supply before installation