

DATA SHEET



ZWARTE LED-LINEAIRE LAMP 18W 600MM



AVAILABLE MODELS

Color Temp	REF No
3000K	907463
4000K	907464
6000K	907465

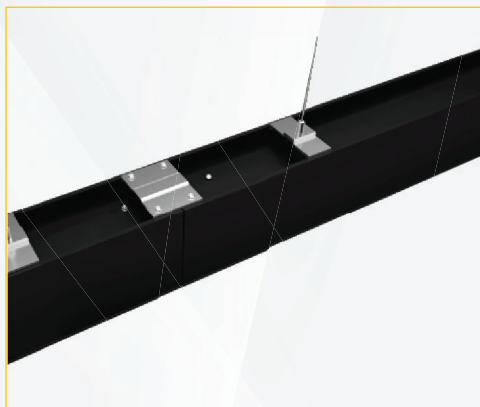

DATA SHEET



ZWARTE LED-LINEAIRE LAMP 18W 600MM

ELECTRICAL DATA

Wattage (Consumption)	18W
Voltage	AC200-240V
Power Factor	≥0.5

PHOTOMETRICAL DATA

Temperature (Kelvin)	3000K, 4000K, 6000K
Light color	White
Luminous efficiency	110LM/W / 120LM/W
Lumen	1980LM±10% / 2160LM±10%
Beam angle	120°
Color Rendering Index (CRI)	≥0,80

CAPABILITIES

Dimmable	No
----------	----

LIFESPAN & WARRANTY

Lifespan	50.000 hrs
Warranty	5 years

DIMENSIONS & PACKAGING

Product Dimensions	L588*W55*H75mm
Inner box	1 piece
Outer box	20 pieces

ADDITIONAL INFORMATION

Housing color	Black
IP Rating	IP20
Housing color	Aluminium & polycarbonate
Certificates	CE & ROHS

AVAILABLE MODELS

Color Temp	REF No
3000K	907463
4000K	907464
6000K	907465



DATA SHEET



BLACK LED LINEAR LIGHT 18W 600MM

TEST REPORT

IETM NO.:SLL-18WSMD 0.6M

LUMINOUS INTENSITY DISTRIBUTION DIAGRAM

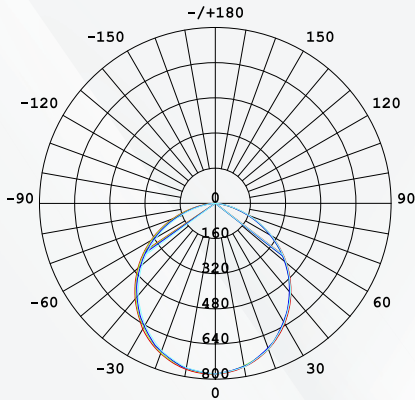

AVERAGE BEAM ANGLE (50%) :107.3 DEG

UNIT:cd

- C0/180,108.7deg
- C30/210,107.6deg
- C60/240,106.7deg
- C90/270,106.2deg

PLANAR ISOLUX DIAGRAM (UNIT: 1X)

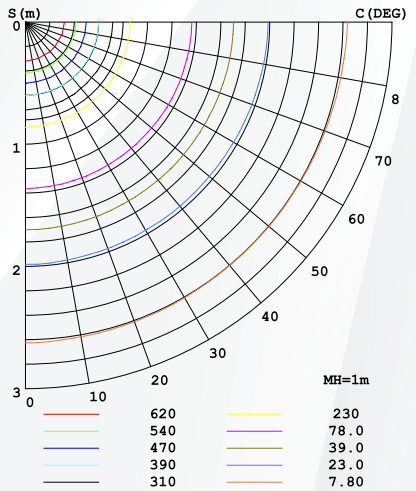

Flux out:1463 lm

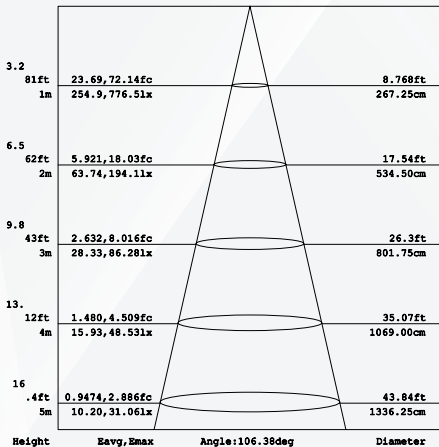

Note: The Curves indicate the illuminated area and the average illumination when the luminaire is at different distance.

DATA SHEET



BLACK LED LINEAR LIGHT 18W 600MM

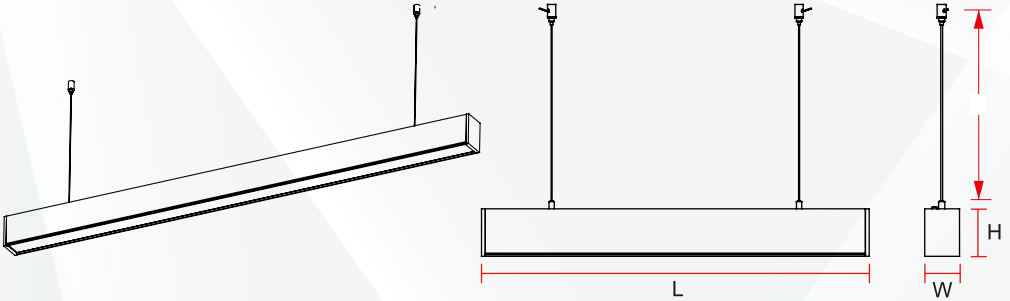

ITEM NO.	POWER	PRODUCT SIZE(L*W*H)	SUSPENSION LENGTH(SL)
SLL-18WSMD	18W	L588*W55*H75mm	1000mm
SLL-36WSMD	36W	L1198*W55*H75mm	1000mm
SLL-48WSMD	48W	L1498*W55*H75mm	1000mm

Suspension length 1000mm is standard configuration, Other lengths can be customized.

MANUAL INSTRUCTION



Safety Notice:

- 1 Installation should be done by registered electricians.
- 2 Never touch the working luminaire
- 3 In any case of malfunction, switch off the power supply immediately, and do not try to repair it yourself.
- 4 Repairment should only be done by registered electricians or official service agent.

Included



Not Included



DATA SHEET

BLACK LED LINEAR LIGHT 18W 600MM

If In Series

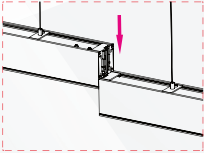

Item No.	Connection / Qty Max(pcs)
SLL-18WSMD	40
SLL-36WSMD	20
SLL-48WSMD	16

This connection QTY refers to the case of direct 1 cable line, If more lamps need to be connected in series, just connect a few more wires; It is recommended that the load of one input line be less than 800W.



WARNING
Switch off the power supply before installation

Suspending



Step 1: Take the kit out of the box;

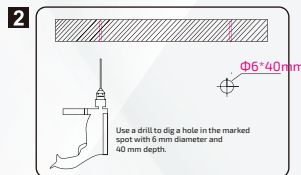

Step 2: Drill holes in the installation position;

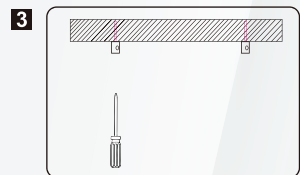

Step 3: Attach the ceiling holder to the ceiling with long screws;

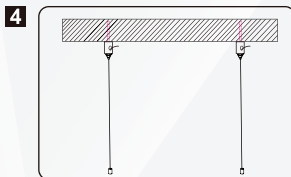

Step 4: Thread the wire rope into the top seat and tighten the wire lock on the top seat;

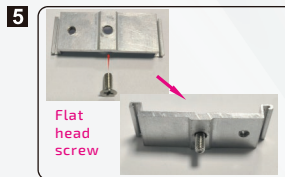

Step 5: Screw the flat head screw to the small aluminum piece;



Step 6: Remove the protective cover from the side of the light fixture by hand, and then insert the small aluminum sheet;

DATA SHEET



BLACK LED LINEAR LIGHT 18W 600MM

If In Series

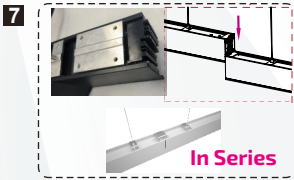

Step 7: If it is in series, it also needs to be loaded with large aluminum sheets;

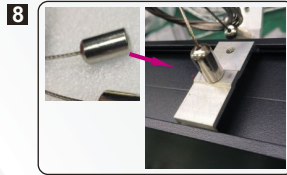

Step 8: Lock the lower end of the wire rope to the screw of the small aluminum piece;

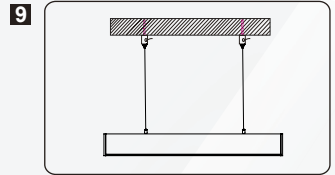

Step 9: Complete installation (rope height adjustable);

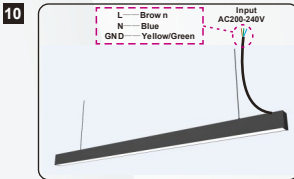

Step 10: Connect the lamp cable to the mains;



Switch off the power supply before installation